

HCH808 Series Enclosure

Weatherproof Environmental Housing

PRODUCT FEATURES

- . For 1/3-inch or 1/2-inch format CCD cameras
- . All aluminum construction
- . Side opening for easy access
- . Available in three lengths
- . Dustproof / IP66 weatherproof
- . Designed for Indoor / Outdoor applications; for use with fixed mount or pan/tilt



The HCH808 series weatherproof environmental enclosure are constructed from die cast and extruded aluminum and are available in 9.5-inch (24.13Cm), 12.5-inch(31.75Cm) or 15.7-inch (39.87Cm) lengths.

These enclosures are for use with 1/2-inch and 1/3-inch format cameras and fixed focal length lenses or motorized zoom lenses (with or without auto-iris operation)

Field installed options include heater, blower and sun shroud.

The enclosures can also be factory ordered with a 24V, 120V , or 230V heater and blower kit.

The side hinged lid provides easy access to the removable camera sled.

Two adjustable (PG10) glands on the rear of the enclosure allow for easy installation of the power and video cables.

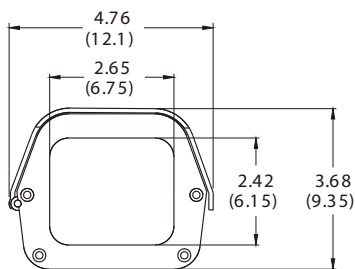

MODEL	A	B	C
HCH808S	11.02 (28.00)	9.44 (24.00)	4.37 (11.10)
HCH808M	14.17 (36.00)	12.59 (32.00)	7.51 (19.10)
HCH808L	17.32 (44.00)	15.74 (40.00)	10.66 (27.10)

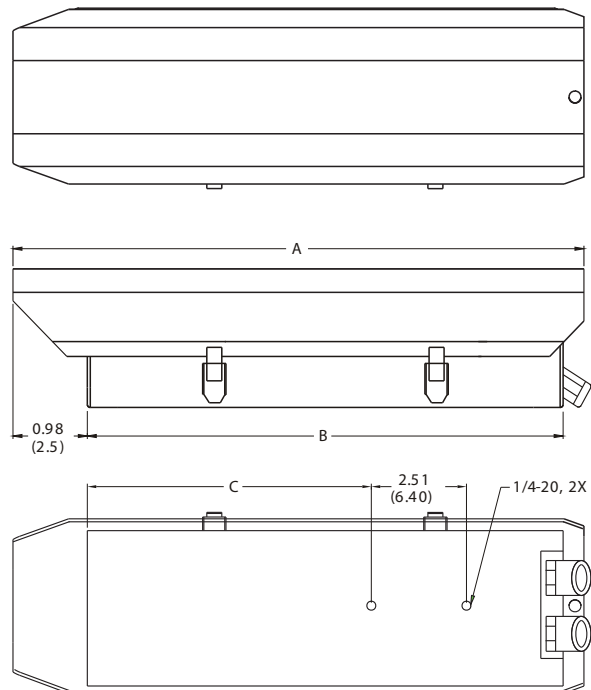

SYSCOM video

Unit: inch(cm)

SPECIFICATIONS

MODELS

HCH808S	Enclosure, environmental, 9.5-inch(24.13Cm) lower body length
HCH808M	Enclosure, environmental, 12.5-inch(31.75Cm) lower body length
HCH808M-1H	Same as HCH808M except has 120V thermostat controlled heater
HCH808M-2H	Same as HCH808M except has 24V thermostat controlled heater
HCH808M-3H	Same as HCH808M except has 230V thermostat controlled heater
HCH808L	Enclosure, environmental, 15.7-inch(39.87Cm) lower body length
HCH808L-1HB	Same as HCH808L except has 120V thermostat controlled heater and blower
HCH808L-2HB	Same as HCH808L except has 24V thermostat controlled heater and blower
HCH808L-3HB	Same as HCH808L except has 230V thermostat controlled heater and blower

GENERAL

Maximum Camera and lens Size	Accepts camera & lens combinations (including BNC connector) up to:	
HCH808S	8.5" L x 3.5" W x 2.5" H (21.59 Cm x 8.89 Cm x 6.35 Cm)	
HCH808M	11.5" L x 3.5" W x 2.5" H (29.21 Cm x 8.89 Cm x 6.35 Cm)	
HCH808M-1H/-2H/-3H	9.5" L x 3.5" W x 2.5" H (24.13 Cm x 8.89 Cm x 6.35 Cm)	
HCH808L	14.5" L x 3.5" W x 2.5" H (36.83 Cm x 8.89 Cm x 6.35 Cm)	
HCH808L-1HB/-2HB/-3HB	11.0" L x 3.5" W x 2.5" H (29.21 Cm x 8.89 Cm x 6.35 Cm)	
Window Size	.11-inch (3.0 mm) thick tempered glass 2.42" H x 2.65" W (6.15 Cm x 6.75 Cm)	
Construction	Die-cast, extruded, and sheet aluminum	
Finish	Light-gray polyester power coat	
Camera mounting	Removable camera sled with Adjustable height	
Housing mounting	Two (2) 1/4-20 tapped holes	
Cable entry	Two .35-inch (9.0 mm) glands on rear of housing	
Rear locking	Located at rear of housing Available for security lock	
Environment	Indoor/outdoor ; -10°F to 120°F (-23.33°C to 48.89°C)	
Dimensions	See dimensional outline	
Weight	Unit	Shipping
HCH808S	2.05 lb (0.93 kg)	2.31 lb (1.05 kg)
HCH808M	2.70 lb (1.23 kg)	3.03 lb (1.38 kg)
HCH808M-1H-3H	2.79 lb (1.27 kg)	3.13 lb (1.42 kg)
HCH808L	3.45 lb (1.57 kg)	3.96 lb (1.80 kg)
HCH808L-1HB-3HB	3.67 lb (1.67 kg)	4.18 lb (1.90 kg)

ELECTRICAL

Input voltage	24 VAC, 120 VAC or 230 VAC, 50/60Hz lower body length		
Power consumption	120 VAC	24 VAC	230 VAC
Heater	30Watts	30Watts	30Watts
Blower	8 Watts	8 Watts	8 Watts
(-1H/-2H/-3H, -1HB/-2HB/-3HB Models only)	Heater activates ON at 42-58oF (6-14oC) and OFF at 72-88°F (22-31°C) Blower activates ON at 77-93°F (25-34°C) and OFF at 62-78°F (17-26°C).		

OPTIONAL ACCESSORIES

HT806-1	Heater kit, 100V ~ 230V, 30W
HT806-2	Heater kit, 24V, 30W
I/O PCB BOARD	Control board with thermostat. One required when instilling a heater, blower or in common
Note; Heater and Blower assemblies require O/IPCB BOARD assembly for connection.	

RECOMMENDED MOUNTS

Wall	
HCS160	Light duty wall mount. Max. load 20lb(9.06kg).
HCS161	Medium duty wall mount. Max. load 30lb(13.6kg).
HCS162	Medium duty wall mount. Max. load 30lb(13.6kg). (Cable feedthrough hole)
HCS163	Medium duty wall mount. Max. load 20lb(9.06kg). (Cable feedthrough hole)
HCS165	Universal medium duty wall mount. Max. load 40lb(18.12kg). (Cable feedthrough hole)
Ceiling/pedestal	
HCS166	Medium duty ceiling "j" mount. Max. load 20lb(9.06kg).
HCS167	Medium duty ceiling "j" mount. Max. load 30lb(13.6kg).
HCS169	Medium duty ceiling/pedestal mount. Max. load 40lb(18.12kg).
Pipe/Pole	
HCS164	Medium duty mount for pipe/pole. Max. load 40lb(18.12kg).
HCS168	Medium duty mount for pipe/pole. Max. load 40lb(18.12kg).

SYSCOM video